

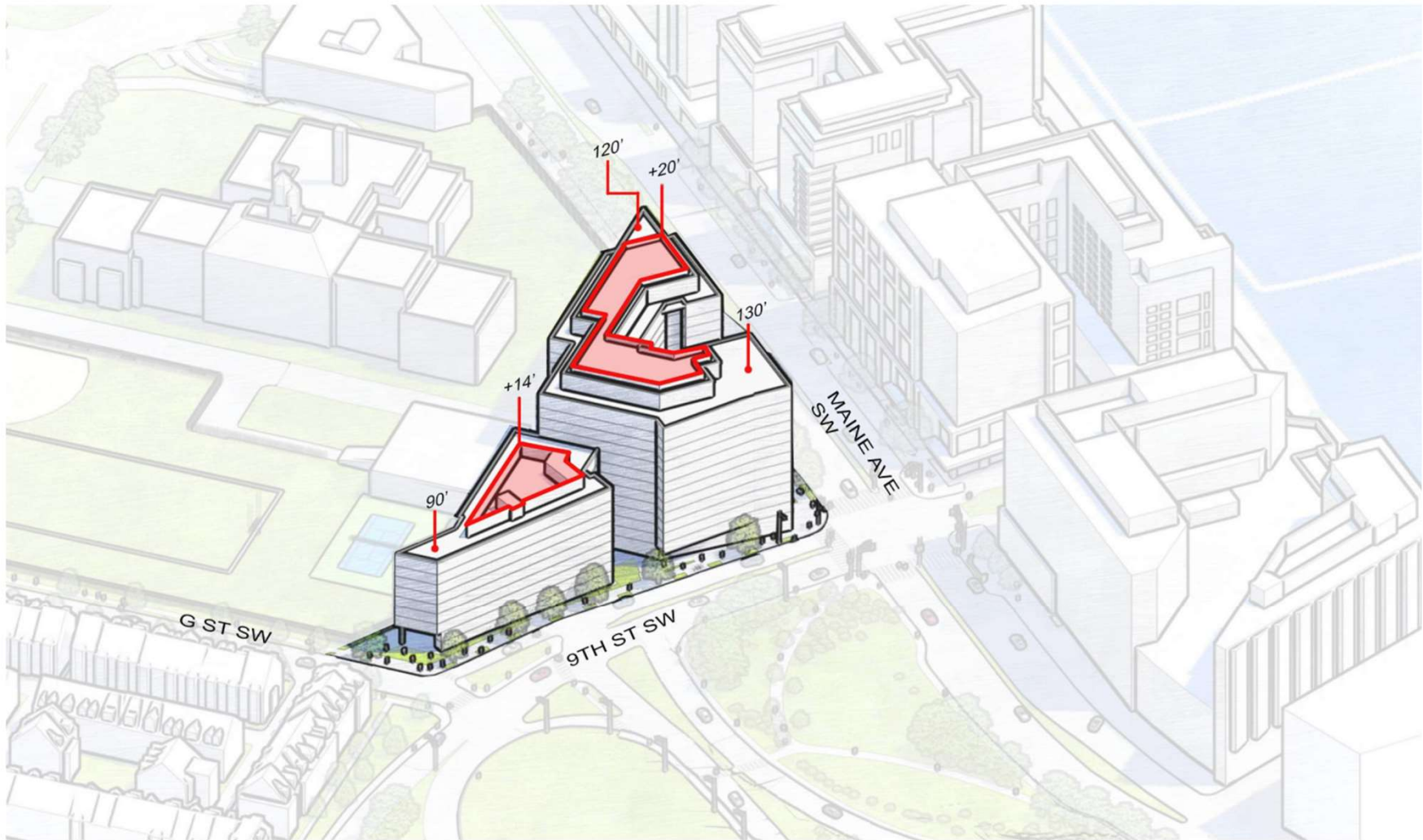

Shadow Study



JAIR LYNCH
REAL ESTATE PARTNERS

PERKINS EASTMAN DC
DESIGNING THE DISTRICT

LandDesign.

WM WILES
MENSCH

899 MAINE AVENUE SW

PROPOSED MASSING
06/03/22

MATERIALS SUMMARY:

1. MASONRY 1
2. MASONRY 2
3. MASONRY 3
4. COMPOSITE METAL PANEL
5. GLAZING SYSTEM
6. GLASS BALCONY RAILINGS

NOTE: ASSUME 40-45% GLAZING AT OCCUPIED AREAS OF PENTHOUSE

GLAZING PERCENTAGE

WEST ELEVATION: 48%
OVERALL: 42%

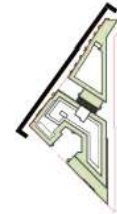

MATERIALS SUMMARY:

1. MASONRY 1
2. MASONRY 2
3. MASONRY 3
4. COMPOSITE METAL PANEL
NOTE: ASSUME 40-45% GLAZING AT OCCUPIED AREAS OF PENTHOUSE
5. GLAZING SYSTEM
6. GLASS BALCONY RAILINGS

GLAZING PERCENTAGE

WEST ELEVATION: 48%
OVERALL: 42%

